

2J0B90-C885G

LTE450 Connector Mount

Key Features

LTE450

- 410-496 MHz

Connector Mount

Low Profile

Ground Plane Dependent

Dimensions 48 x Ø 9 mm



1. Antenna and electrical specifications

Parameters	LTE450 Antenna
Standards	LTE Band 450
Band (MHz)	450 MHz
Frequency (MHz)	410-496
Return Loss (dB)	~-5.5
VSWR	~5.3:1
Efficiency (%)	~40.7
Peak Gain (dBi)	~-1.4
Average Gain (dB)	~-4.4
Impedance (Ohm)	50
Polarisation	Linear
Radiation Pattern	Omni-Directional
Max. Input Power (W)	50
Connector Type	SMA-Male Standard

Antenna Measurement Conditions:

Mounted on Ground Plane of 150x40 mm

Measured in Certified CTIA 3D Anechoic Chamber

2. Mechanical and environmental specifications

Specifications	2J0B90-C885G
Mounting Type	Connector Mount
Dimensions (mm)	48 x Ø 9
Radome	TPC-ET
Radome color	Black
Operating Temperature (C)	-40 to +85
Storage Temperature (C)	-40 to +85
Substance Compliance	RoHS

3. Antenna parameters

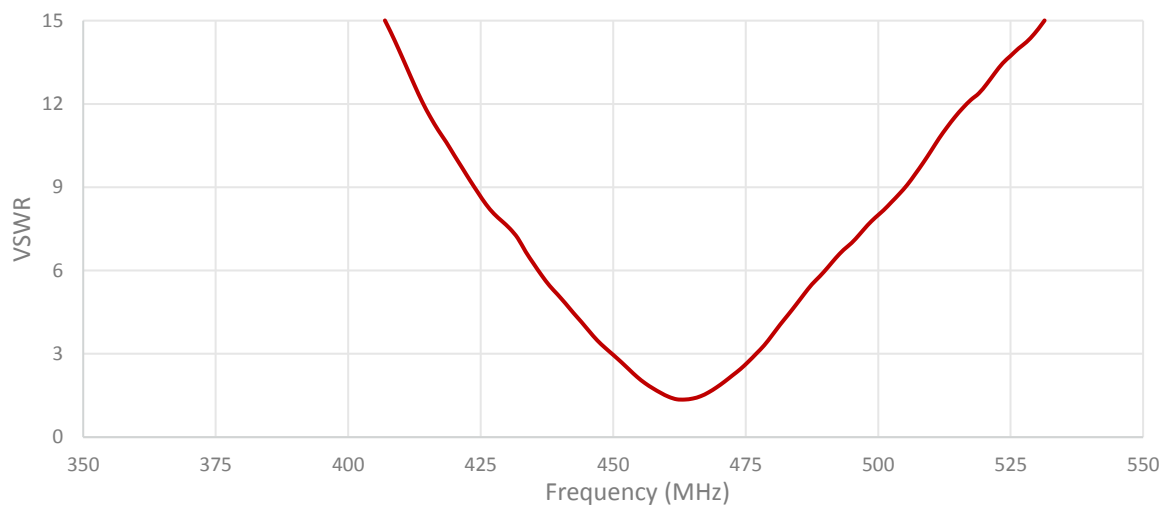
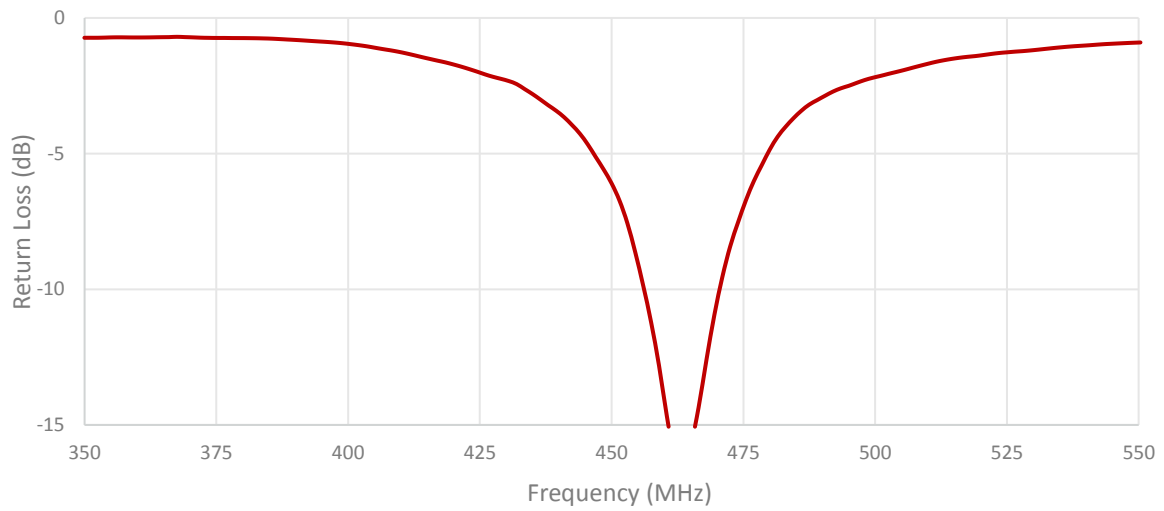

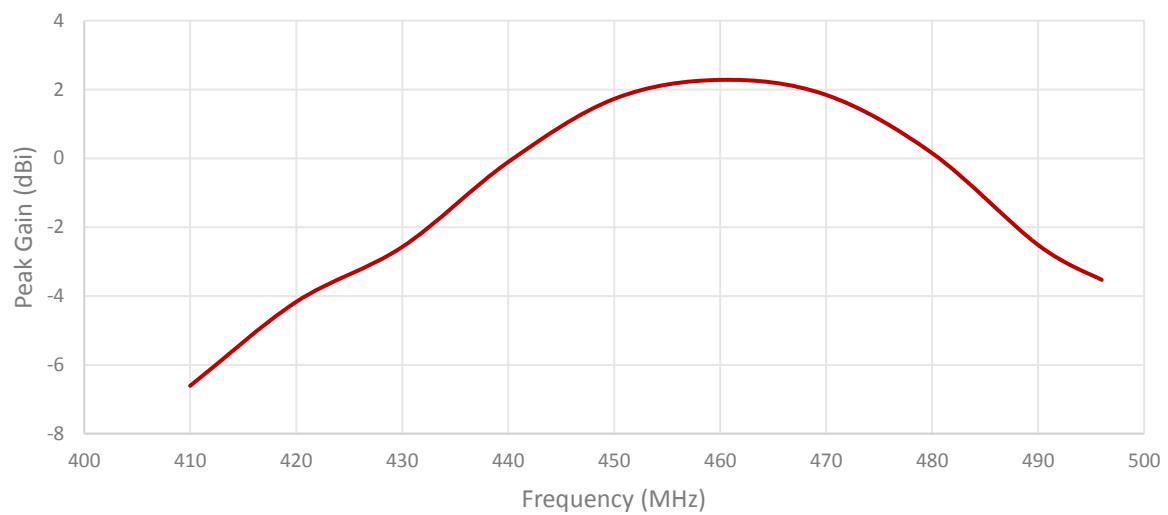
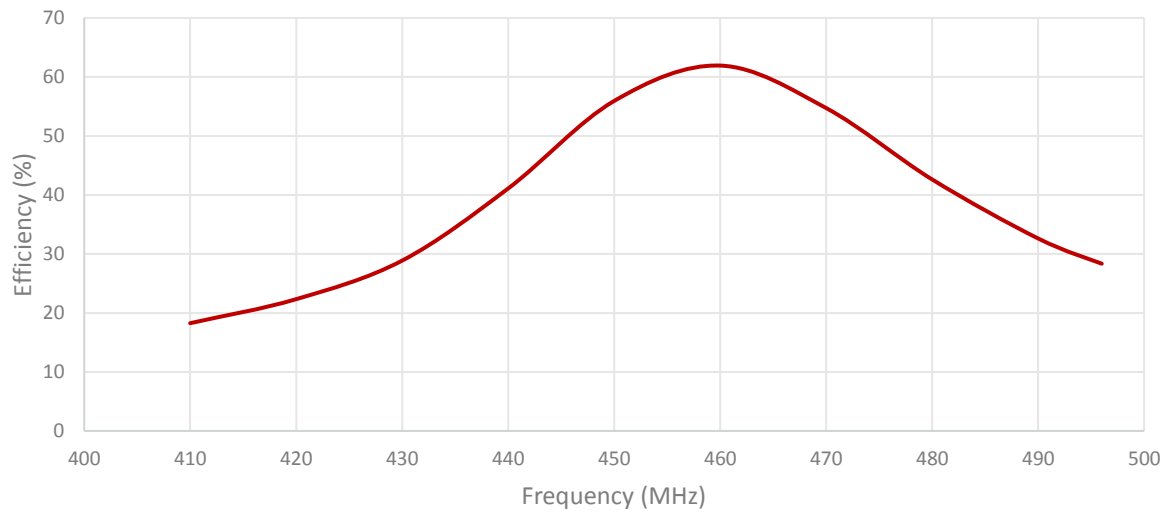

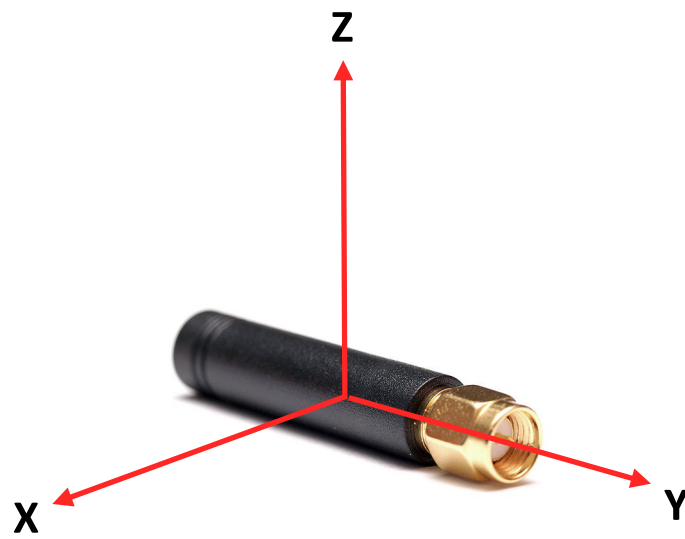
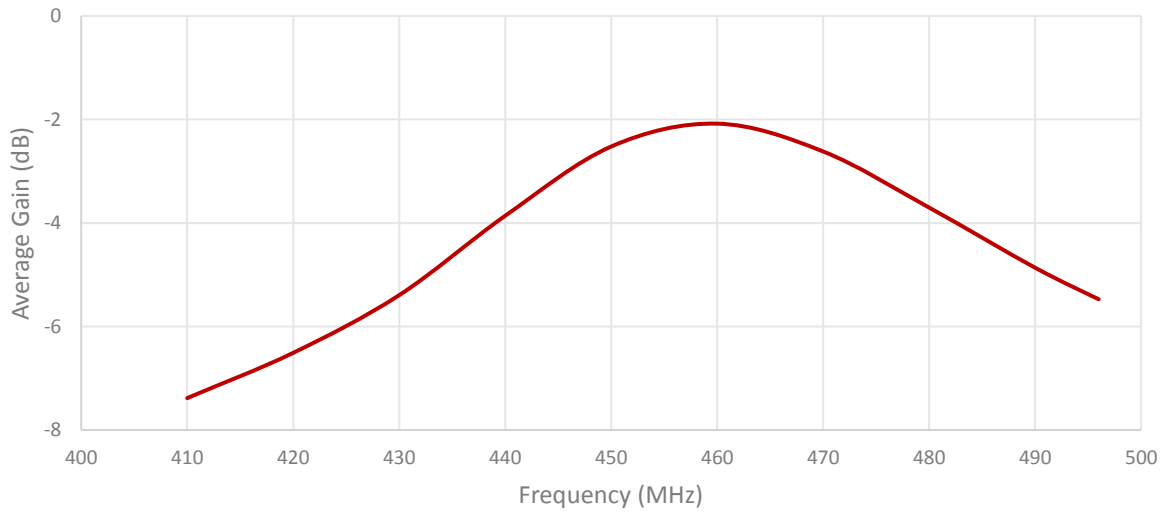

Radiation pattern reference

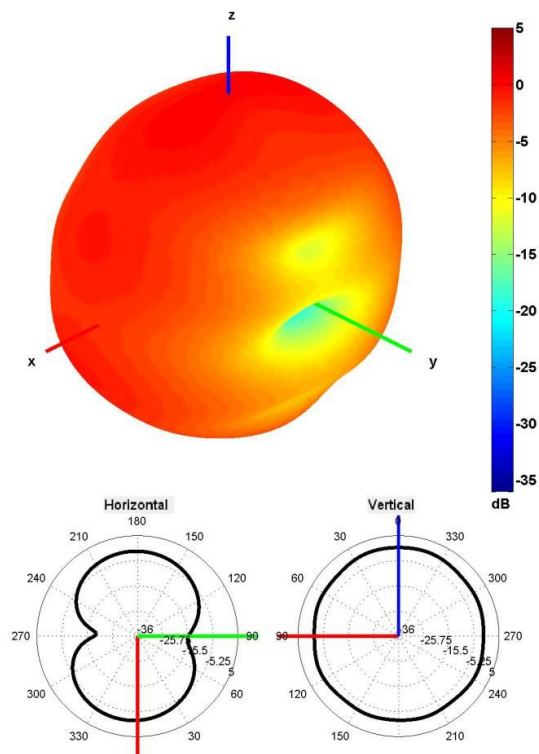

450 MHz Radiation pattern

4. Antenna drawings

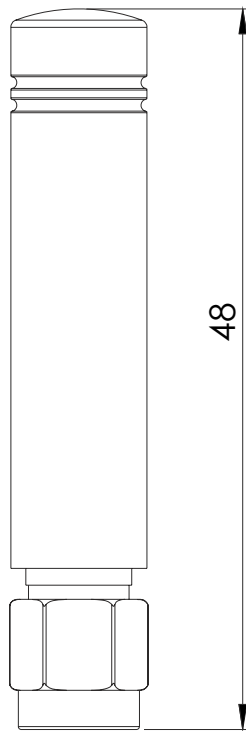
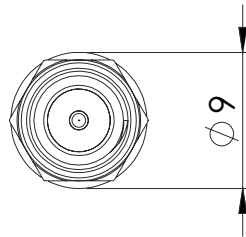

5. Antenna Images

