

2J0502-C115N

2.4/5.0 GHz ISM Connector Mount

Key Features

2.4/5.0 GHz ISM

- 2410-2490 MHz

- 4920-5925 MHz

Connector Mount

Ground Plane Dependent

Dimensions \varnothing 15.7 × 58.2 mm

Certificates: IP67



1. Antenna and electrical specifications

Parameters	2.4/5.0 GHz ISM Antenna	
Standards	WiFi, BT, ZigBee, ISM	
Band (MHz)	2.4 GHz	5.0 GHz
Frequency (MHz)	2410-2490	4920-5925
Return Loss (dB)	~-7.0	~-9.8
VSWR	~2.6:1	~2.1:1
Efficiency (%)	~52.2	~53.1
Peak Gain (dBi)	~-2.8	~-2.4
Average Gain (dB)	~-2.8	~-2.8
Impedance (Ohm)	50	
Polarisation	Linear	
Radiation Pattern	Omni-Directional	
Max. Input Power (W)	25	
Connector Type	Most RF Connectors (RP-SMA-Male Standard)	

Antenna Measurement Conditions:

Mounted on Ground Plane of 70x35 mm

Measured in Certified CTIA 3D Anechoic Chamber

2. Mechanical and environmental specifications

Specifications	2J0502-C115N
Mounting Type	Connector Mount
Dimensions (mm)	Ø 15.7 × 58.2
Radome Type	TPE
Radome color	Black
Operating Temperature (C)	-40 to +85
Storage Temperature (C)	-40 to +85
Substance Compliance	RoHS
Certificates	IP67

3. Antenna parameters

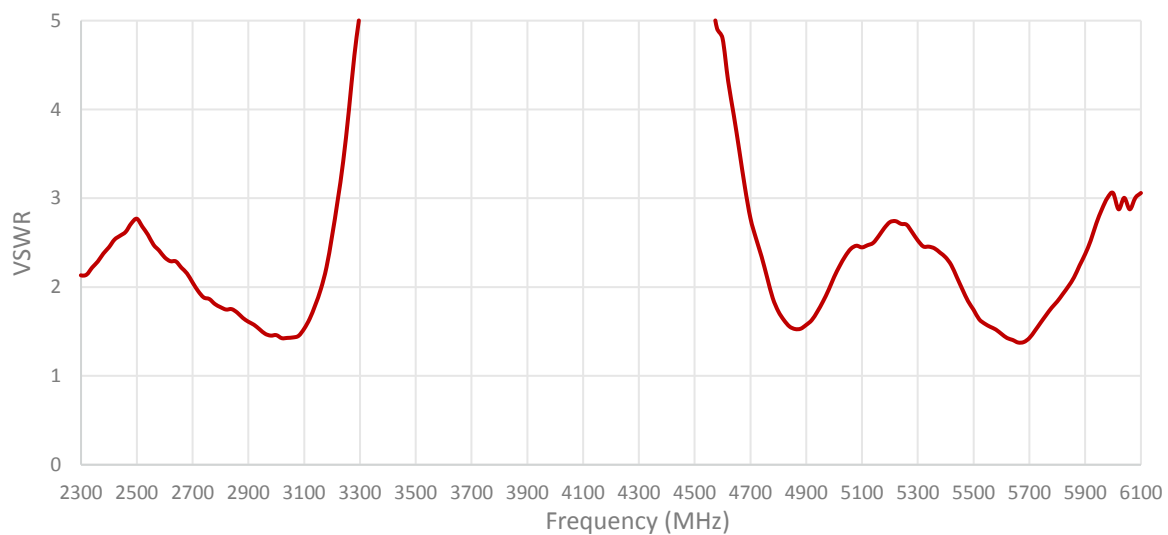
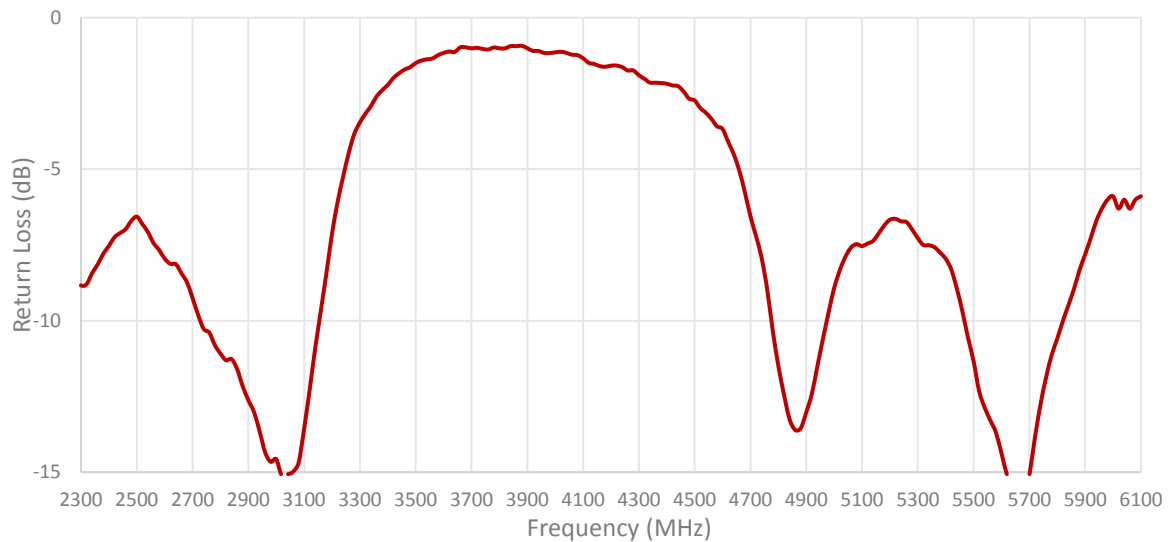

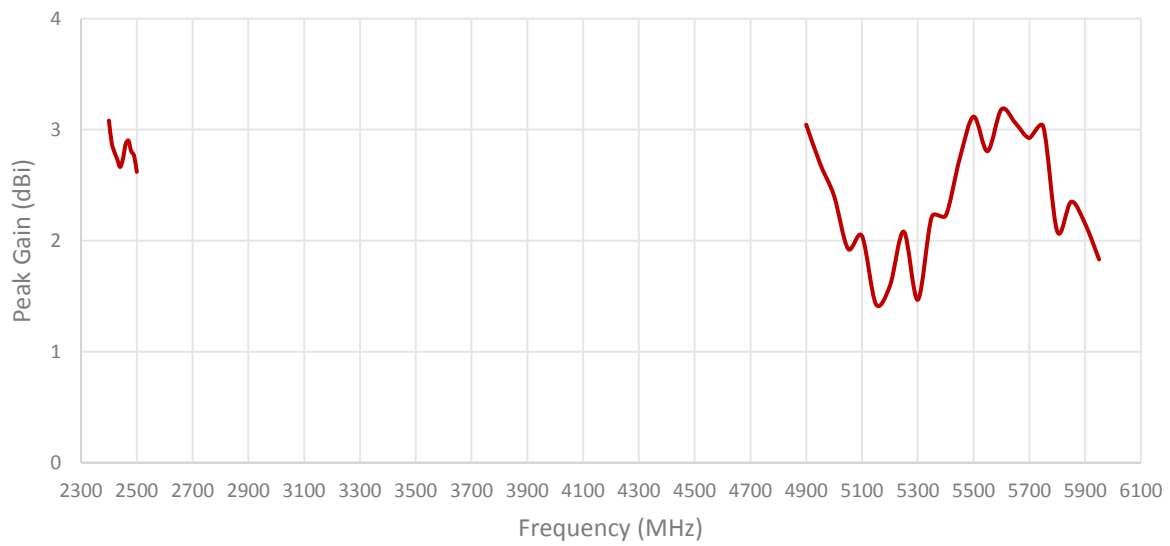
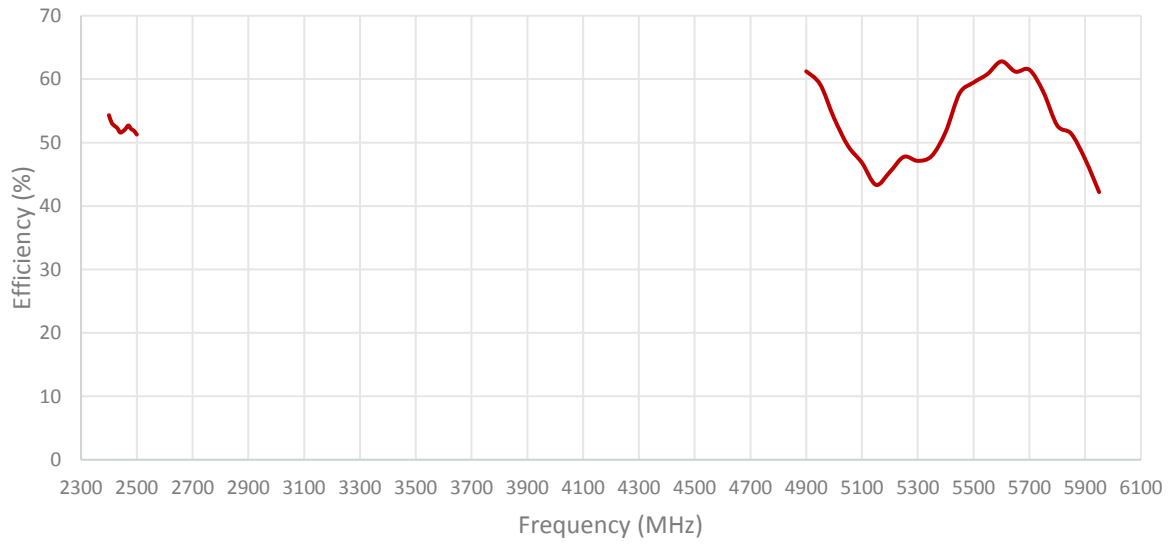

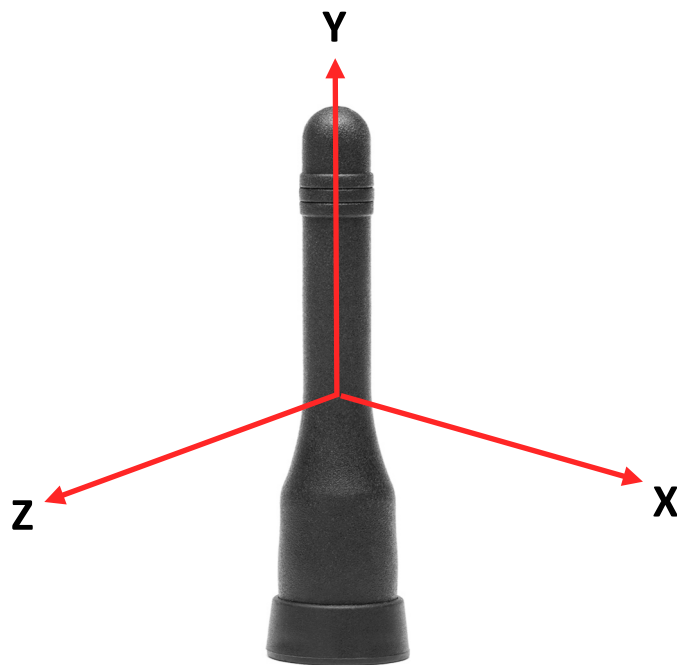
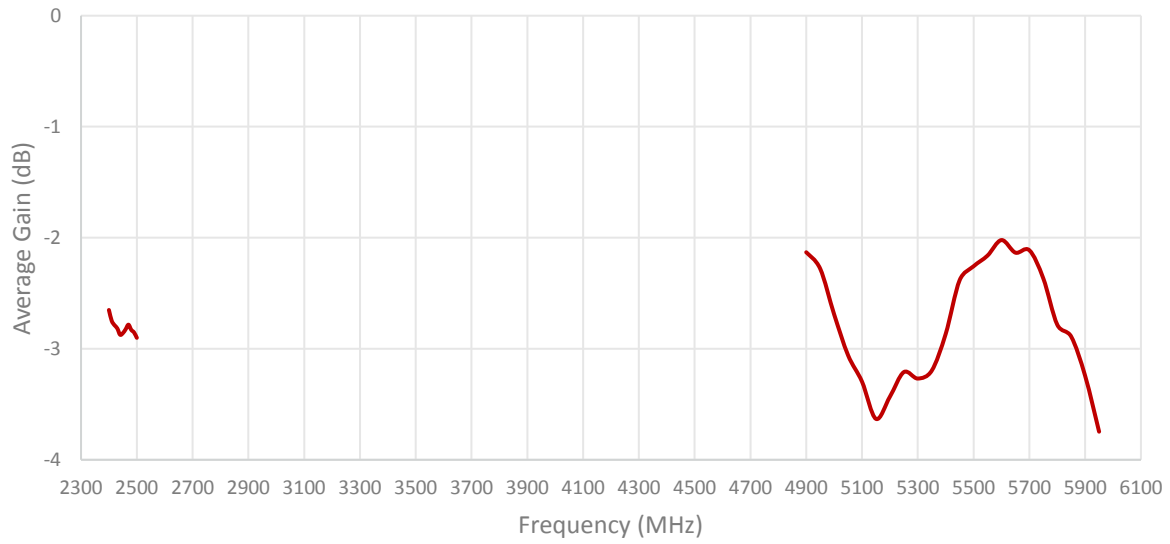

Radiation pattern reference

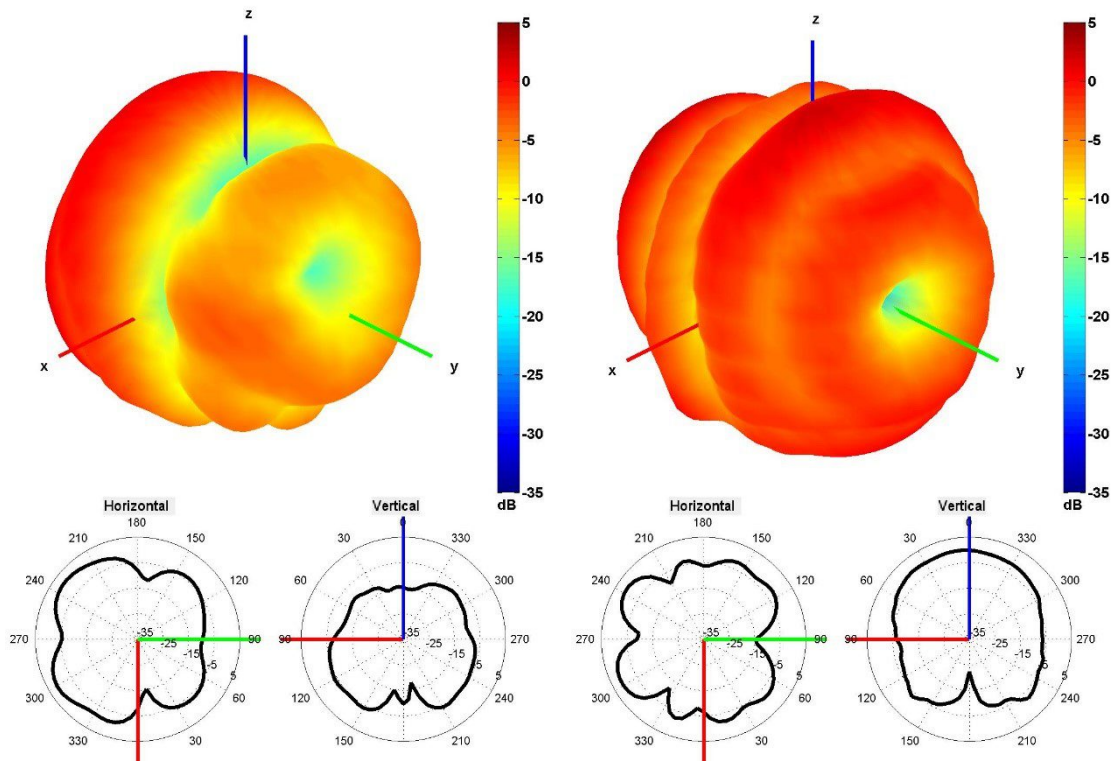

2450 and 5500 MHz Radiation pattern

4. Antenna drawings

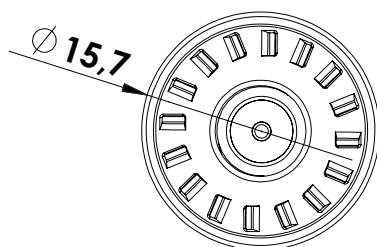
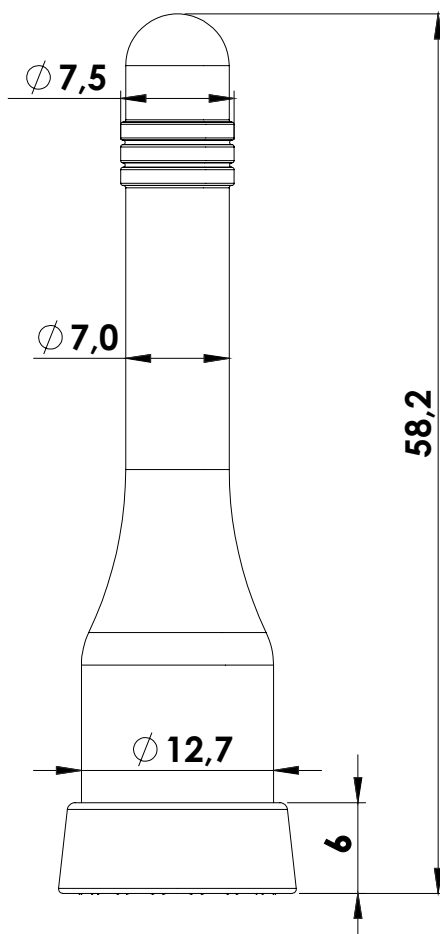

5. Antenna Images

